

Pos. No	Title	Quantity
EL1	OXYGEN SENSOR	8
J2	ASSY OF WATER DRAIN	1
J4	ASSY OF LEFT BATTERY CONTAINER	1
K1	ASSY OF RIGHT BATTERY CONTAINER	1
K2	ASSY OF T-PIECE	2
N3	ASSY OF RIGHT ELECTRONICS UNIT	1
N4	ASSY OF LEFT ELECTRONICS UNIT	1
O1	ASSY OF SCRUBBER STICK	2
P1	ASSY OF O2 SENSOR BRACKET	2
P2	ASSY OF OIL CYLINDER	1
U5	ASSY OF MTH PLUG	2
X1	ASSY OF INJECTOR	2
1	CAP	1
3	COVER	2
7	KNOB	1
20	SCREW	1
27	WASHER 2	2
28	CLIP	2
29	BOLT	2
30	PLATE	2
33	AXLE	2
34	PIN	2
35	SHAFT 1	4
353	SINGLE BENCH	2
420	DRB TOP CAP	1
578	TANGUM TUBE 1/8	2x0,22m
628	O-RING BS115	2
630	O-RING BS117	2
637	O-RING BS129	1
643	O-RING BS355	2
671	SCREW M3x8	8
672	SCREW M3x16 CSK	4

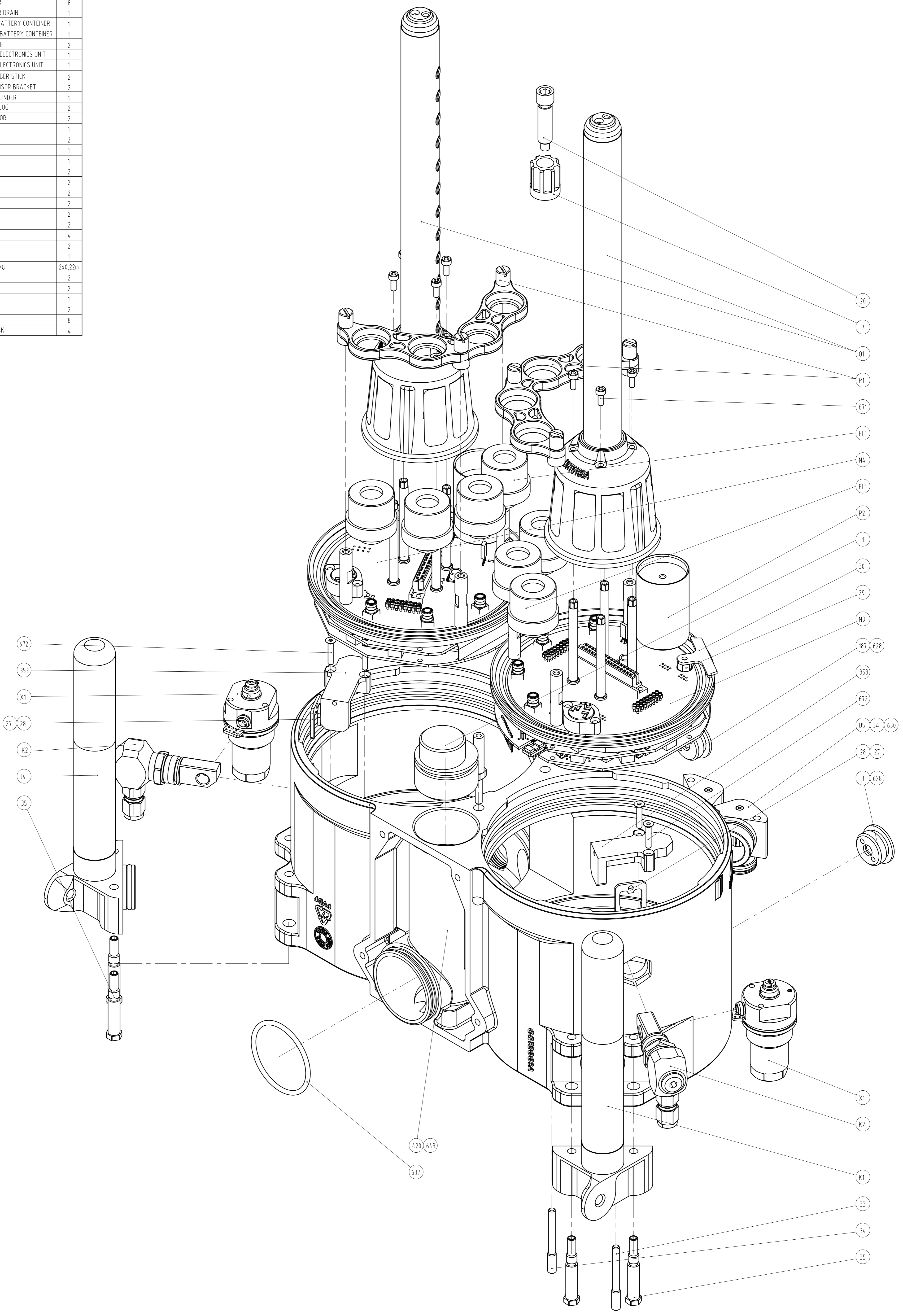

Units of measurement	mm UNLESS OTHERWISE STATED	Mass	5,2 kg	Format	ISO A1	Designed by	A.KUDRIASHOV	Changed by	-	Approved by - date	A.BOGATCHEV	Filename	ORT2000A.dwg	Date	07.06.2008	Scale	1:1
Material		Quantity	SEE BOM	Projection		<b>DEEP LIFE LTD</b> Strictly Commercial-in-Confidence, copyright (c) 2008. Copying prohibited except as provided for under written contract with Process Insight Ltd.			Title/Name <b>ASSY OF DRB TOP CUP</b>		Drawing number	ORT2000	Edition	A	Sheet(s)	10	